



S-5600 USER MANUAL

▲ Notice

Please read this manual before installation and operation.

⚠ Safety precautions



Do not disassemble or alter the lock.

Assembling or disassembling the door lock may damage the product. Damages to the product caused by unauthorized persons may result in damages to your property. Please contact our customer service.



If the product generates harmful gases and smoke.

Please remove the batteries immediately from the product, if you do not take this step immediately, the product may suffer server damage.



Please keep the product away from water or any liquids.

If the product is exposed to salty water or liquids, please wipe off the moisture with a soft cloth. If moisture or foreign materials penetrate the product, remove the batteries immediately and contact the service agency or customer service center for advice. Using a product contaminated with foreign may cause problems.



Please check the batteries every 6months to see if the batteries are leaking and to check the cleanliness of battery terminals.

If leakage is discovered, please wipe out with a dry cloth and replace the new batteries. In case of exposure to leakage, wash with soap and water immediately.



Do not clean the product with flammable materials such as alcohol, benzene or thinners.

Such materials may damage the surface or cause a fire.



Batteries should not be exposed directly to heat source or flames.

Batteries should not be exposed directly to heat source or flames or submerged in water, because they may leak or explode, resulting in severe damage. Please do not use damaged batteries.



Do not allow the battery electrodes to contact metals such as key holders.

As the battery may overheats, cause explosion or severe damage.



Please do not close the door with the deadbolt in the locked position.

It may damage the product or cause a malfunction.



Do not force to pull the front cover.

It may damage the product or cause a malfunction.



Please do not mix old with new batteries or use different types.

The battery life is getting shorter and it may cause a leaks or explosions.



It may damage the product when installed on a heavy dew condensation door.

Dew condensation; small drops of water that form when warm air touches a cold surface. Please check the environment for install area. Heavy dew condensation may damage the product or cause a malfunction.

Product features



Panic release handle type

It facilitates escapes while in danger opening easily with a simple action of lever down.



High reliance mechanical mortise lock type

It has high reliability mechanical mortise lock type with installing the locking device on door body inside.



Free-direction mortise lock type

The mortise lock of this product facilitates easy adjusting to left or right handle direction.



Auto-relocking function

If users do not open the door after unlocking, it is to be locked automatically for higher security.



Volume control

8 levels of volume.



One touch mute function

Open the door in quite not to interrupt neighbor without any operating sound temporarily.



Low battery indicator and alarm for battery replacement time

Low battery indicator with alarm sound shows battery replacements time.



Trespass alarm function

When the door is opened by force with hammer or other lock is suspended with alarm sound.



Prevent mischief & hacking

With 5 times of abnormal try with wrong number, function of door lock is suspended for a while with alarm sound.



Three way solution (PIN code, card key, emergency key)

Available to use one solution of PIN code, card key, emergency key.



Disable function when missing PIN code or card keys

Automatically, deleted old PIN code or card key information when registering new one.



Random security coding function

When you enter your home with someone, you don't want to show PIN code to them. In his case, you may press any number randomly without limitation and then enter your PIN code at final. Then you can open the door without revealing your PIN code.



Auto lock function

When the door is closed, to be locked status automatically.

Product composition and components

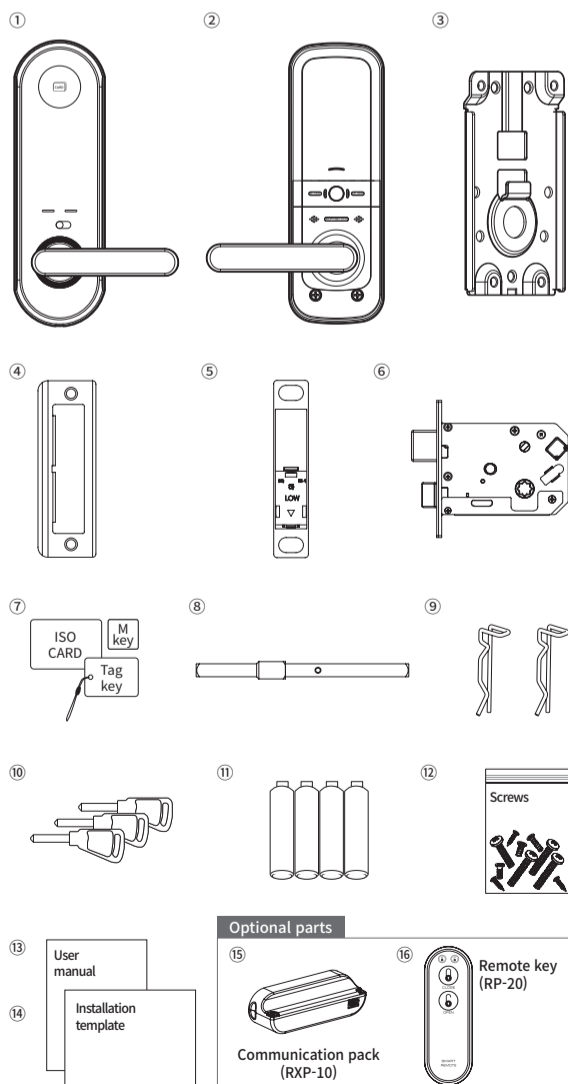

Name	Product specification	Remark
① Front Ass'y	84mm(W) x 260mm(H) x 21mm(D)	Including rubber pad
② Back Ass'y	82mm(W) x 242mm(H) x 34mm(D)	
③ Back bracket	70mm(W) x 119.5mm(H) x 6.6mm(D)	
④ Strike	35mm(W) X 106mm(H) X 6.3mm(D)	
⑤ Strike housing	21mm(W) X 106mm(H) X 19.5mm(D)	
⑥ Mortise lock	105.4mm(W) X 110mm(H) X 25mm(D)	
⑦ Card key	ISO card, Tag key, Mobile tag key	
⑧ Handle shaft	96mm(W) X 8mm(H) X 8mm(D)	
⑨ Handle shaft clip	2 EA	
⑩ Emergency key	3 EA	
⑪ Battery	1.5V 'AA' Size LR6 Alkaline, 4ea(DC 6V)	
⑫ Screws	1 set	
⑬ User manual	Main User manual	
⑭ Installation template	Using for making hole at the door	
⑮ Communication pack	Communication pack	Optional
⑯ Remote key	Remote key	Optional
※ Installation condition	Door thickness 40~80mm	

Factory setting

Item	Setting Status	Ref.page
Auto/Manual lock mode	[Auto-lock]	8
Beep sound level (1~8 level)	8 level	7
Factory setting PIN code	123456	-

Name and function of each part

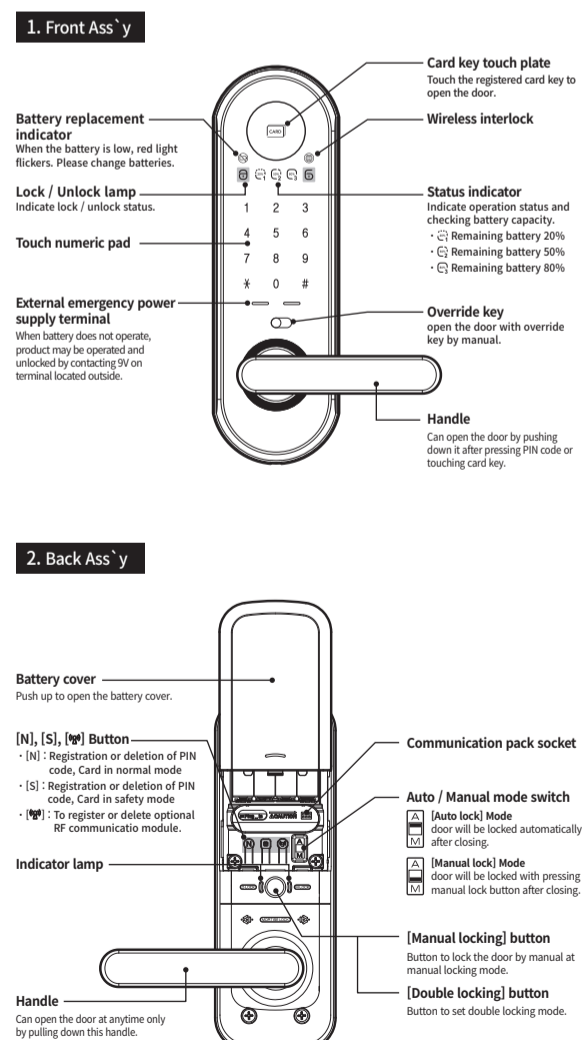

Description shortcut icons

: [N] button	: PIN code	: Trespass alarm
: [S] button	: Card key	: Unlock
: [*] button	: 9V alkaline battery(6LF22)	: Lock
# button icon"/> : [#] button	: User code	: Smartphone application
: Touch the front pad	: Manager code	: Authentication code
: [Communication function] button	: Registration new code	: Open button on application
	: Random code	

※ Normal mode : [N] button / Safety mode : [S] button

How to replace battery

If battery lamp in RED is flickering with sound, separate battery cover, and replace all 4 battery to new one, 6V(1.5V "AA" size LR6 Alkaline)

How to apply external power in the emergency

PIN code			# button icon"/>		Card key		
----------	--	--	------------------	--	----------	--	--

Additional function

How to control operation volume							
Vol. up		# button icon"/>		or		# button icon"/>	3
Vol. down		# button icon"/>		or		# button icon"/>	2
Guest PIN code (Temporary use)							
REG.		# button icon"/>		or		# button icon"/>	7 RC # RC #
Warning function against mischief or hacking							
Operate	Wrong PIN code 5 times or unregistered card key 5 times						
Warning alarm function against trespassing by force							
PIN code		* button icon"/>		* button icon"/>	Card key		
<p>① Note</p> <ul style="list-style-type: none"> Press 1 to make maximum level and press 0 to make mute in one time. After setting, pull down the handle and close the door. 							

How to unlock / lock from outdoor

How to unlock from outdoor							
PIN code			* button icon"/>		Card key		
How to unlock from outdoor (Mute function)							
PIN code				* button icon"/>			
Card key							
How to lock [Auto lock / Manual lock] from out door							
Auto lock			※ If the door is not closed correctly, warning sound can be caused. Please check and confirm the door closing status.				
Manual lock							
How to set auto-locking / manual-locking							
Auto lock			In Auto locking mode, door will be locked automatically after closing. In Manual locking mode, door will be locked with pressing manual lock button after closing.				
Manual lock			* Please do the change/registration of new code at door opened status to prevent unintentional locking.				

How to unlock / to lock from Indoor

① Note

- Before closing the door, make sure that deadbolt is not extrude.
- If the door is not closed correctly, warning sound can be caused. Please check and confirm the door closing status.

1. In Auto-locking mode

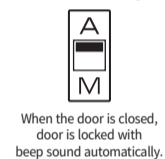

2. In manual locking mode

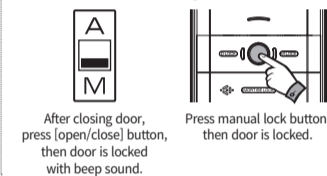

How to use random security coding function

Usage				* button icon"/>	
-------	--	--	--	------------------	--

How to open from indoor

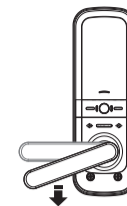

"PANIC RELEASE TYPE"

Just pulling down the handle, door lock is opened anytime.

What's "PANIC RELEASE"?

Door can be opened with simple action of pulling down the handle. Even the door lock is out of order, people can escape easily in the emergency such as fire etc.

How to set double locking function

1. [Double locking] Set-up

(Open/Close), [Double lock] button press 3 sec

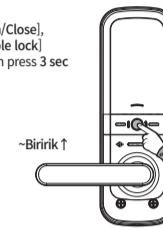

2. [Double locking] Cancel

Press (Open/Close), [Double lock] button or pulling down the handle.

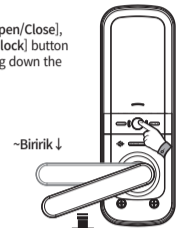

① Note

- [Double locking] mode shall be installed after door is closed.
- Even in [Double locking] mode, it is available to open the door from in door by pulling down handle.
- With pulling down handle from indoor, [Double locking] mode shall be released automatically.
- Even in [Double locking] mode, intrusion warning is working properly.
- If the sound is set to mute, there is no status sound. Only indicating lamp is flickering.

How to change Normal mode / Safety mode

- Normal mode : ideal for new users or low security environments
- Safety mode : higher security level via use of a manager Secret code. Provides individual register and delete function

: [N] button	: [S] button	: Card key								
: User code	: Manager code	: Registration new code								
How to change from normal mode to safety mode										
	1	2	3	4	5	6	7	8	9	10
Safety mode			# button icon"/>		# button icon"/>		# button icon"/>			
How to change from safety mode to normal mode										
Normal mode			# button icon"/>		# button icon"/>		# button icon"/>			

Normal mode

· PIN code : 10 entries (6~12 digits) / Card key : 20 entries

: [N] button	: Registration new code	: Card key								
REG.	PIN code			* button icon"/>	...	* button icon"/>				
	Card key			...	* button icon"/>					
DEL.	All Card key		8 button icon"/>	# button icon"/>	3-sec icon"/>					

※ Repeat highlighted part of diagram above for continuous register or delete

Safety mode

△ Warning : Please do not forget manager code.
If you forget this number should contact to your local agency.

· Secret code: 10 EA (6-12 digits) / Card key: 50 EA

Safety mode												
	1	2	3	4	5	6	7	8	9	10	11	12
REG.	Secret code		1 button icon"/>	4 button icon"/>		or		# button icon"/>	RC button icon"/>	* button icon"/>	* button icon"/>	
	Card key		1 button icon"/>	5 button icon"/>		or		# button icon"/>	Card Registration Number(2digits)	# button icon"/>		* button icon"/>
DEL.	All Card key		2 button icon"/>	5 button icon"/>		or		# button icon"/>				
	Individual Card key		3 button icon"/>	5 button icon"/>		or		# button icon"/>	Card Registration Number(2digits)	# button icon"/>	* button icon"/>	
Safety mode (Manager)												
Change	Manager code		8 button icon"/>	4 button icon"/>		or		# button icon"/>	RC button icon"/>	# button icon"/>	RC button icon"/>	# button icon"/>
REG.	Manager Card key		8 button icon"/>	5 button icon"/>		or		# button icon"/>		# button icon"/>	* button icon"/>	
DEL.	All manager Card key		8 button icon"/>	6 button icon"/>		or		# button icon"/>	5 button icon"/>			

※ Repeat highlighted part for continuous register or delete

Auto locking function / Auto relocking system

1. Auto-locking function

When the door is closed, it will be locked automatically.

2. Auto-relocking system

If the door is not opened within 7 seconds after input PIN code or card key it will be relocked automatically to protect user's property.

Communication pack / Remote key

1. How to install the communication pack

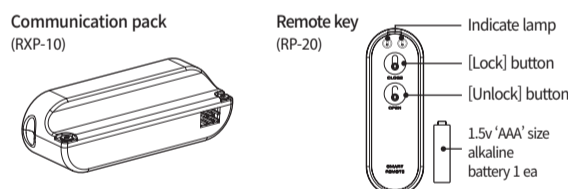

Purchase the wireless communication pack and remote key separately and plug the pack in the socket located below the batteries.

- 1 ea battery is equipped.
- To replace battery, open the back cover.

Installing communication / Mobile Access pack

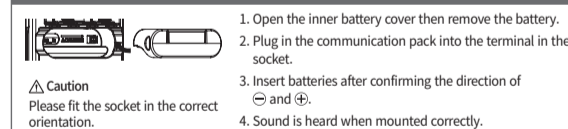

- Open the inner battery cover then remove the battery.
- Plug in the communication pack into the terminal in the socket.
- Insert batteries after confirming the direction of ⊖ and ⊕.
- Sound is heard when mounted correctly.

2. How to register remote key & to unlock / to lock

· Remote key : 5 EA

: [N] button 6 button icon"/> : Remote unlock Lock icon"/> : Remote lock

To register / delete remote key (Communication pack)							
REG.	Remote key		6 button icon"/>	or	Lock icon"/>	* button icon"/>	
DEL.	All remote key		9 button icon"/>	# button icon"/>	3-sec icon"/>		
How to lock/unlock by remote key							
Unlock	6 button icon"/>						
Lock	Lock icon"/>						

※ Repeat highlighted part for continuous register or delete.

Mobile access Set-up and use

: [Communication function] button : PIN code
 : Smartphone application : Authentication code
 : Open button on application

Smartphone										
REG.		1 button icon"/>		# button icon"/>	Smartphone application icon"/>	XXXX icon"/>	# button icon"/>			
ALL DEL.		2 button icon"/>	C button icon"/>	# button icon"/>						
Send family key										
Send		# button icon"/>	C button icon"/>	# button icon"/>	6 button icon"/>	Smartphone application icon"/>	XXXX icon"/>	# button icon"/>		

※ Please follow detailed instructions given on the smartphone application for highlighted parts.

How to unlock with mobile key (using smartphone)

Open in safe mode
 : Safe mode Open button icon"/> : Click Open button icon"/> open button on smartphone application to unlock the door

※ Wireless connection between smartphone and door lock may result in distance and/or time differences based on your network connection.

How to set up smartphone to use mobile key

- Download Schlage Access application on your smartphone from the app store.
- Register and log into the app.
- Follow instructions from the app installation guide to register the door lock.
- When you unlock the door lock using the app for the first time, press Open button icon"/> open button on the app, followed by 1 on door lock's numeric pad to check connection.

⚠ Caution

Check if you can't unlock due to disconnect between smartphone and door lock

- Make sure smartphone power is "on".
- Make sure you're logged into the app, and it's active.
- Make sure your smartphone's Bluetooth function is on
- If you activate or deactivate the app and/or Bluetooth function, the app disconnects from the lock and deactivates the mobile key.
- If you wish to reuse the mobile key, turn on the app and the Bluetooth function, press Open button icon"/> open button on the app, followed by 1 on door lock's numeric pad to reconnect and activate the mobile key.
- You must keep the app "on" and Bluetooth "on" at all times to use the mobile key without reconnection.